

FICHE
TECHNIQUE
DATA SHEET

Presentation trolley
Reference: MC000617

www.hygeco.com





Presentation trolley



Reference: MC000617



1. Product description

Hygeco offers a mobile stainless-steel trolley, particularly useful for post-mortem rooms to complete body handling system. The smooth-rolling castors allow the trolley to be pushed wherever it needs to be applied. It can be used alone or together with one of our washing units. Despite its simple design the trolley has all necessary qualities to facilitate the simple and easy transfer to/from a mortuary lifting trolley or storage facilities coolers.

The frame is rigid. The frame is fabricated of 304 stainless steel. It is provided with four wheels – two of them with brakes. The body tray is locked with a locking system attached to the rail of the trolley. It is easy to operate. The tray remains locked preventing the body tray from slipping during transport.

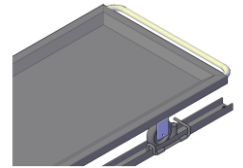

Various options and accessories are available to complement the basic model and make it perfectly adapted to the specificities of each autopsy laboratory (see paragraph 3).

2. Technical data

Length:	1600mm
Width:	600mm
Height:	660mm
Weight:	20 kg
Wheels:	4 wheels – 2 with brake \varnothing 125mm
Load capacity:	200 Kg
Stainless steel:	304

3. Accessories and options



Removable Body Tray on wheels: Fabricated of 304 stainless steels. The tray offers the standard rolled edge construction. All corners are welded with a continuous bead; two hand slots are provided on each end of the tray for ease of handling. Available in two widths and with or without drain holes.

Reference:	Product designation
MC000607	Standard curved body tray 2000 x 580 mm
FP000061	Standard curved body tray 2000 x 580 mm with drain whole
MC000611	Bariatric curved body tray 2000 x 750 mm
FP000062	Bariatric curved body tray 2000 x 750 mm with drain whole



Reference: **MC000999 Washing and drainage unit "basic"** Important furniture to complete functional post-mortem laboratory equipment. The simple washing unit is equipped with a rear splashguard and stainless-steel stamped sink allowing the washing of the body. Its anti-runoff edges and overflow tube ensure maximum operator safety. Very easy to use with its mixing HW/CW elbow control tap and a flexible hand shower of 3 meters.



Reference: **MC000665** the trolley is provided with a tilting top end. It allows the body tray to be sloped towards a washing unit.



4. Drawing

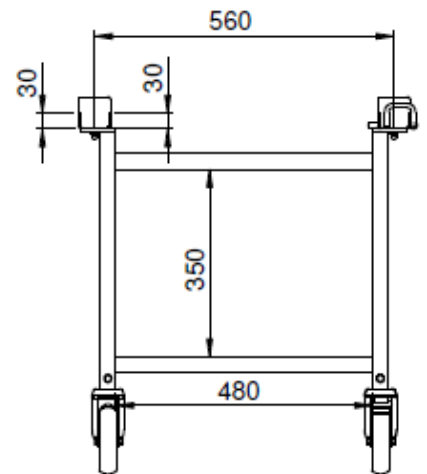
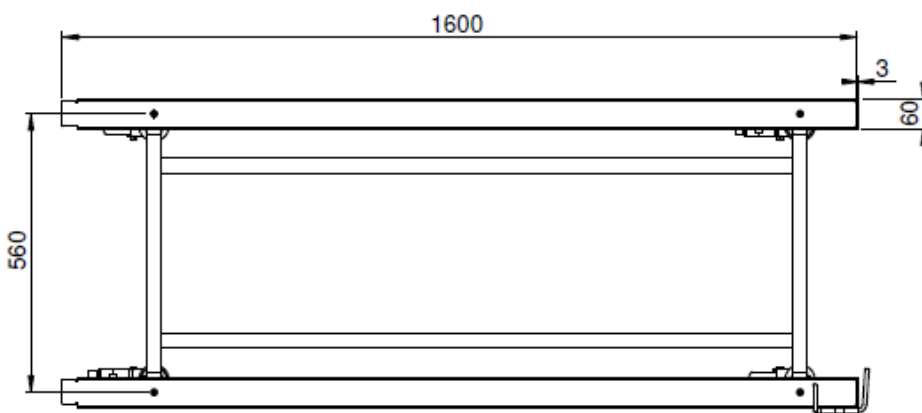
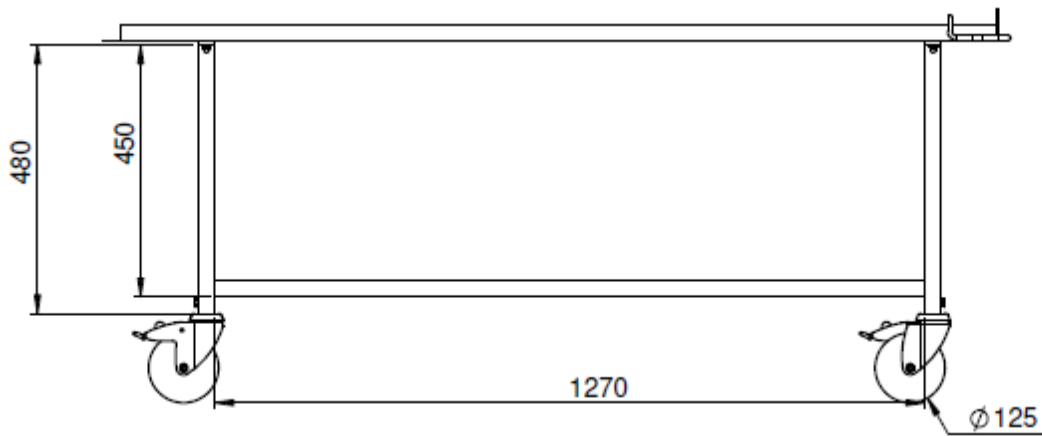



5. CE marking / Norms / ISO

Hygeco International products holds the ISO 9001: 2015 certification registered under No. FR084950-1 valid until December 18, 2026.

We certify that our products are conditioned, packaged and labelled in compliance with standards in accordance with our internal charter and considering the specific requirements of our customers.

